

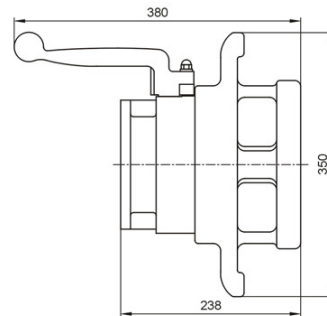

API Bottom Loading Coupler **JLK-61A**



The JLK-61A is the one we Jialong specially developed for the bottom loading system with the feature of "Drip Less". It is designed and produced accordance with API RP1004, coupling to APR RP1004 coupler, detaching with "Drip Less", ensuring the loading is safe and environmental friendly.

Technical Data

Max. Working pressure	75Psi / 5bar
Max. Flow rate	600GPM / 135m ³ /H
Temperature range	-30 ~ +80°C
Pressure difference	2-5Psi
Net weight	8.4Kg

Benefit and Features

- The coupler is used widely and with the special design gasket to resist low temperature, damage and light fuel.
- **With the Interlock Design**
When the coupler is in the non-working condition, it will be lock itself to avoid the wrong operation.
- **5 Cam Lock Design**
Ensures the tight connection with the valve at the bottom of the tanker and efficiently protect from the side forces.
- Special sealing design structure, avoid danger of sealing gasket rushing out when quick filling.
- **Hardening Treatment**
All the aluminum parts are hardened, all the other connecting parts are stainless steel with the superior, reliable quality, and long working life.
- **Easy Servicing**
Users can maintain it under our instruction.

Holding Device **TKPT01**



TKPT02

